

SNAP SAMPLER DEPLOYMENT (PAGE 1 OF 2)

INSERTING AND SECURING BOTTLES

Version 01-10

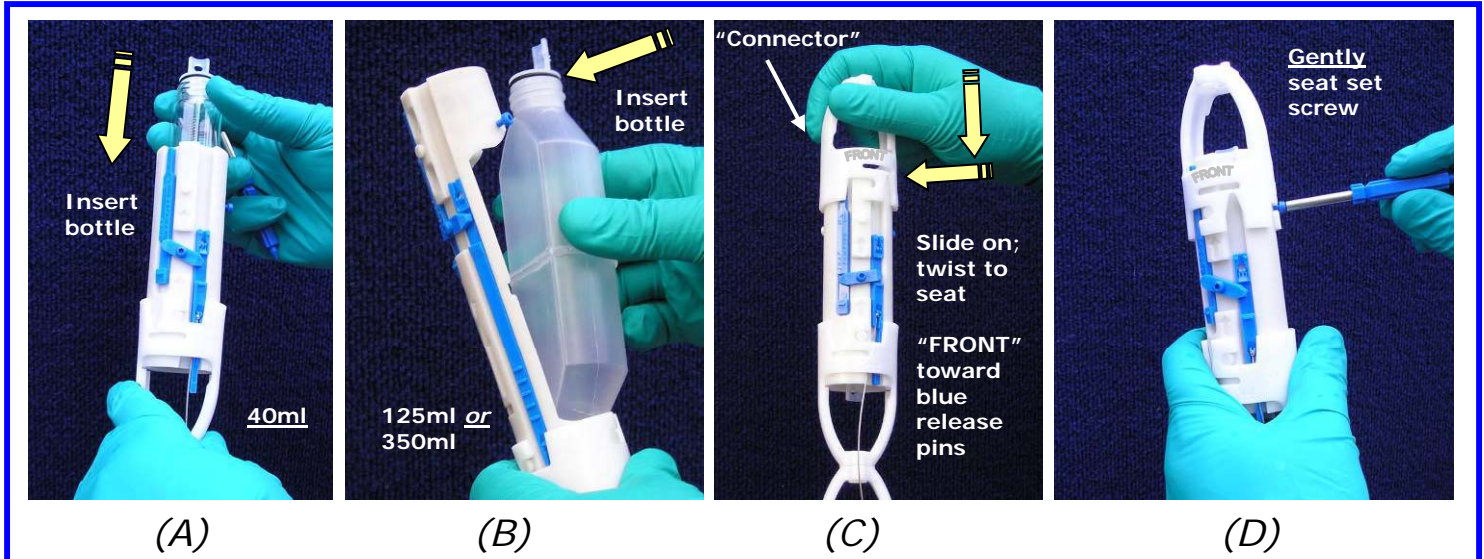

- A) Insert 40 ml VOA into top of 40 ml Snap Sampler...
- B) Insert 125ml or 350ml POLY into back side of 125 ml Snap Sampler.
- C) Slide twist-on "Connector" over sampler and twist clockwise to seat—the word "FRONT" should appear above the blue release pins.
- D) Gently secure connector with blue set screw.
- E) Set All Bottom Snap Caps First, then Top Snap Caps. Insert Snap Driver blade into the upper hole of the concave side of Snap Cap;
- F) Push down on Snap driver handle to lift Snap Cap; grasp driver or use thumb to push driver down; keep fingers clear of the under-side of the driver tool.
- G) Pivot on the notch in the driver handle until driver handle is flush/parallel with sampler body and Snap Cap is in its seat.
- H) Push release pin up through lower hole in the Snap Cap; repeat "E" through "H" for each Snap Cap and all Samplers.

SETTING SNAP CAPS

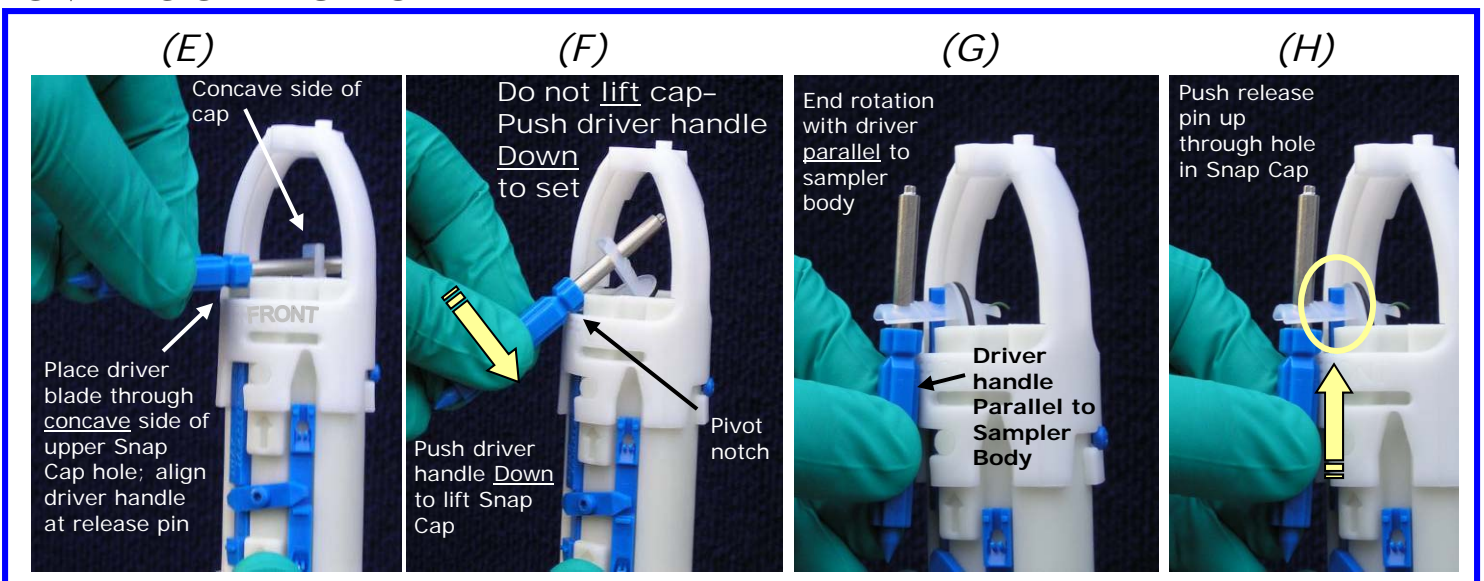

SNAP SAMPLER DEPLOYMENT (PAGE 2 OF 2)

ATTACHING MANUAL TRIGGER

Version 01-10

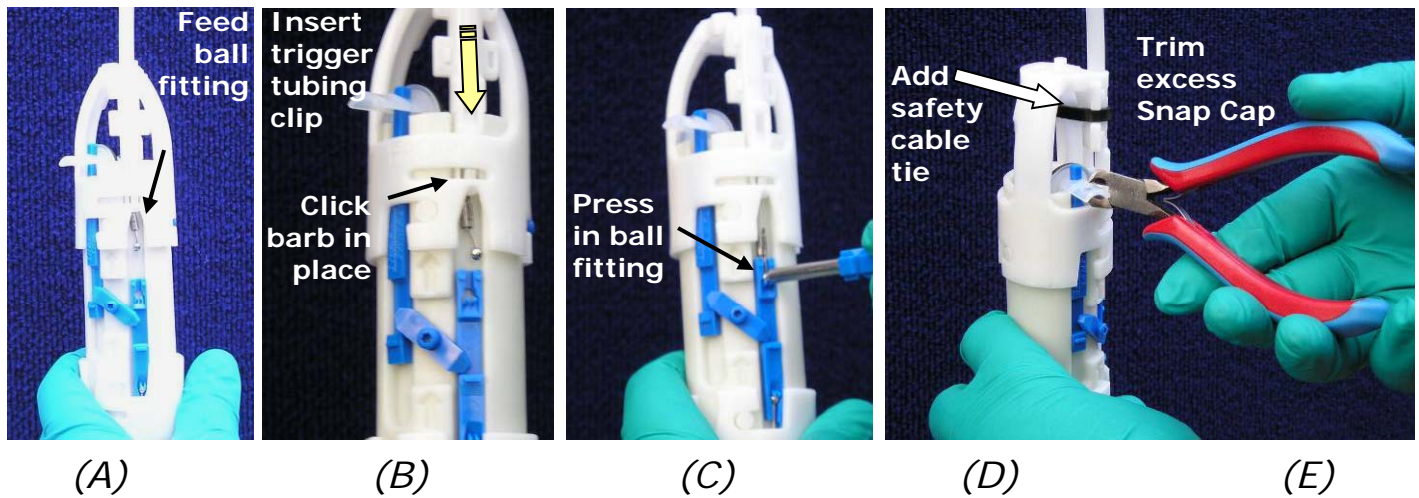

- A) Insert trigger in right/upper release pin groove—feed ball fitting first.
- B) With **trigger barb facing out**, insert trigger until barb **clicks** into position.
- C) Press ball fitting into release pin using Snap Driver Tool.
- D) Attach safety cable tie.
- E) Trim protruding Snap Caps between ribs (required for smaller diameter wells). Where more than one sampler is attached to one trigger, **connect ball-end connector cables between each sampler** (not shown).
- F) Lower Sampler to depth; seat trigger clip into ramp on Dock Ring.
- G) Close and lock well cap.
- H) To sample, **pull trigger cable while holding Dock Ring in place**; remove trigger from dock and retrieve samplers.

WELL HEAD DOCK ATTACHMENT

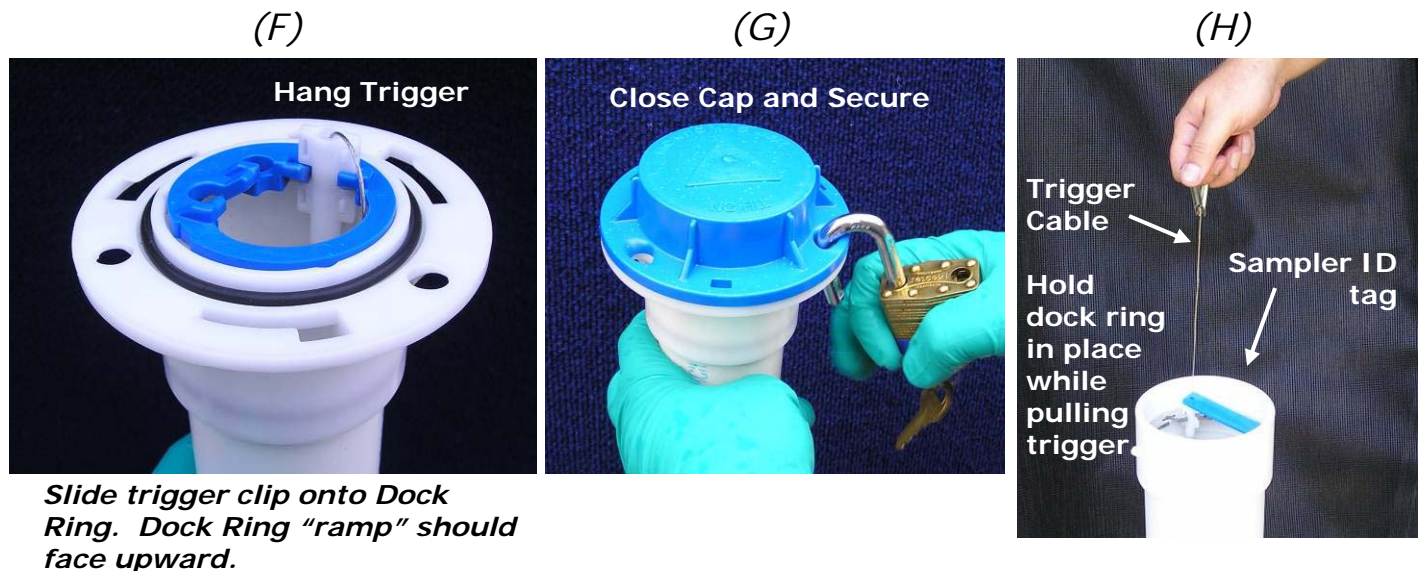

Slide trigger clip onto Dock Ring. Dock Ring "ramp" should face upward.